

Q-FLEX

USB CHARGING TYPE A/C (12W + PD45W)

- Size: Standard 1-1/8"
- Type A: 12W (no quick charging)
 - Current Rating: 2,4A ,Voltage: 5 VDC
- Type C : PD 45W
 - Current Rating: 2,25A ,Voltage: 20 VDC
 - Current Rating: 3.0 A ,Voltage: 5 V,9V,12V,15VDC
- Operating Temperature: -25°C ~ 85°C



IP65



Salt Spray 8H



Fast Charging



RoHS

Key Features

- Input: DC 12/24V (Dual Voltage), 5A
- LED Power Indication (Blue ,Green, Red 3 color options)
- PD45W Fast Charges to 80% within about 35 mins
- Total 57W Output Max
- Overvoltage protection 33V DC
- Also charges Macbooks & Macbooks Air in 20V mode

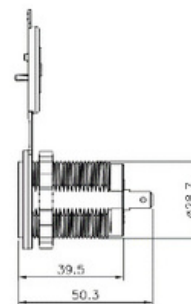
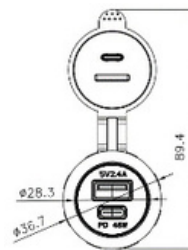

**Recommended Panel
Cut-Out**

VISIT OUR WEBSITE
www.q-flex.fi

CONTACT US
info@q-flex.fi

USB CHARGING TYPE A/C (QC3.0,18W + PD65W)

- Size: Standard 1-1/8",
- Type A : QC 3.0 , 18W
 - Current Rating: 3A ,Voltage: 5 VDC
 - Current Rating: 2A ,Voltage: 9 VDC
 - Current Rating: 1.5A ,Voltage: 12 VDC
- Type C : PD 65W
 - Current Rating: 3,25A ,Voltage: 20 VDC
 - Current Rating: 3.0 A ,Voltage: 5 V, 9V,12V,15VDC
- Operating Temperature: -25°C ~ 85°C



IP65



Salt Spray 8H



Fast Charging



RoHS

Key Features

- Input: DC 12/24V (Dual Voltage), 5A
- LED Power Indication (Blue ,Green ,Red 3 color options)
- PD65W Fast Charges to 90% within about 35 mins
- QC18W Fast Charges to 50% within about 35 mins
- Total 83W Output Max
- Overvoltage protection 33V DC
- Also charges Macbooks & Macbooks Air in 20V mode

SWITCH (LED LIGHTS SURROUND)



WIDE COMPATIBILITY

Fits for most 12V-24V vehicles, marine, ATV, motorcycle, truck, golf cart, RV, boat, SUV, etc.

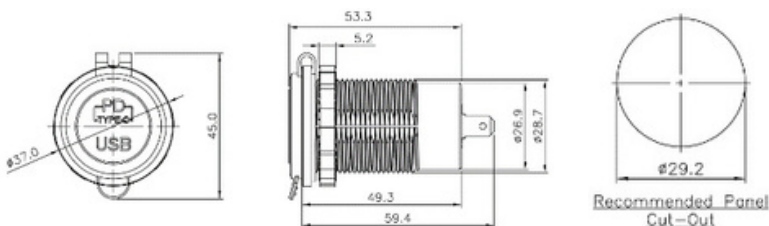

VISIT OUR WEBSITE
www.q-flex.fi

CONTACT US
info@q-flex.fi

REV.	ECN NO.	DATE	SIGN	DESCRIPTION
01	-	2024/03/06	Jiahe Lin	New Initial.

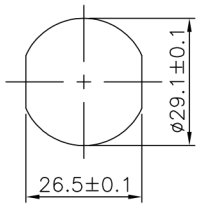

Recommended Panel Cut-Out

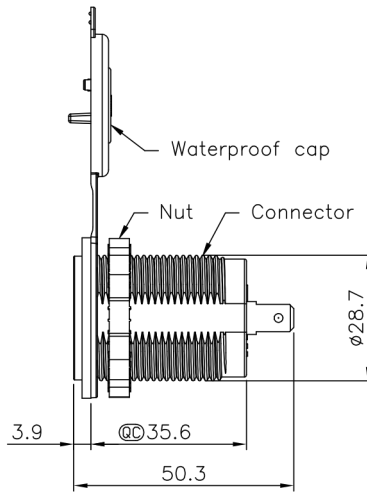
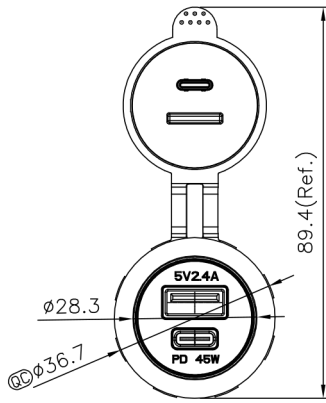
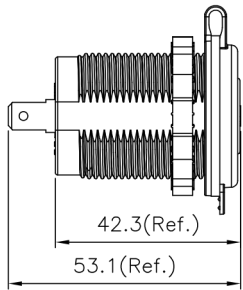
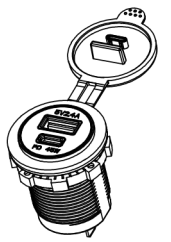
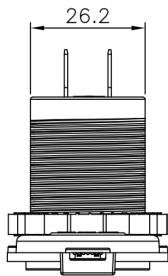

- Note:
- * RoHS Compliant
 - * @Important dimension
 - * Waterproof rate: IP65 (Mated with waterproof cap)
 - * Connector: Thermoplastic, Black
 - * Waterproof Cap: Rubber, black
 - * Nut: Thermoplastic, Black
 - * Type A port power: 12W
 - * Type C port power: PD 45W

UNIT:mm		TITLE USB, CHG USB A+C TYPE, FRONT FASTENED, F, F, TERMINAL, QUICK	Amphenol LTW	ITEM NO CUD-00PFFE-QC5001	DRAWN BY Jiahe Lin	DATE 2024/03/06
TOLERANCE .X ±0.25 .XX ±0.1 .XXX ±0.05 ANGLES	SCALE 5:4	SHEET 1 OF 1	安費諾亮泰企業股份有限公司	DWG NO CUD-00PFFE-QC5001	CHECKED BY Fisher Wang	DATE 2024/03/06
REV. 01	SIZE A4	@: Inspection Item		CUSTOMER ALTW	APPROVED BY Kevin Hu	DATE 2024/03/06

THIS DOCUMENT IS SUBJECT TO CHANGE WITHOUT NOTICE. IT IS CONFIDENTIAL AND A PROPERTY OF AMPHENOL LTW. DISCLOSURE TO THIRD PARTY HAS TO BE AUTHORIZED BY AMPHENOL LTW.

8WI0814-03-表冊 01A2

VISIT OUR WEBSITE
www.q-flex.fi

CONTACT US
info@q-flex.fi

REV.	ECN NO.	DATE	SIGN	DESCRIPTION
01	-	2024/03/06	Jiahe Lin	New Initial.

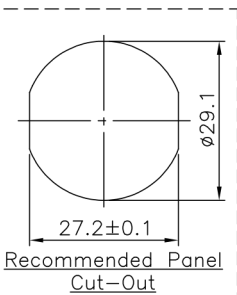
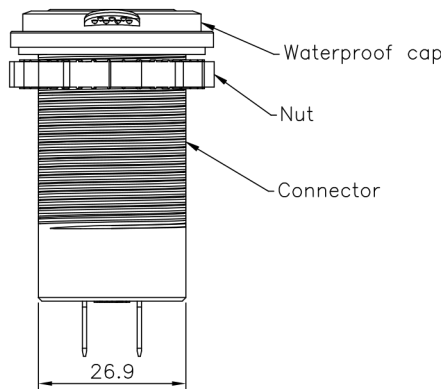
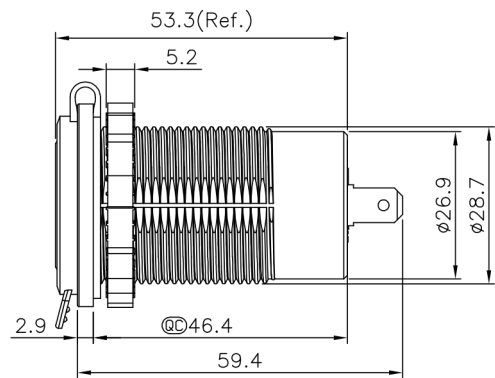
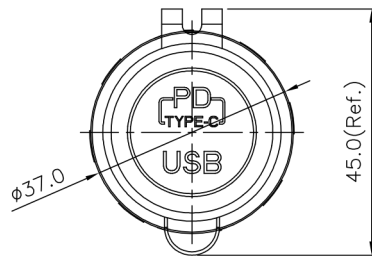
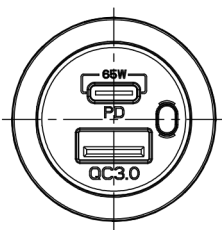

- Note:
- * RoHS Compliant
 - * @ Important dimension
 - * Waterproof rate: IP65 (Mated with waterproof cap)
 - * Connector: Thermoplastic, Black
 - * Waterproof Cap: Rubber, black
 - * Nut: Thermoplastic, Black
 - * Type A port power: QC3.0 18W
 - * Type C port power: PD65W

UNIT:mm	TITLE USB, CHG USB A+C TYPE, FRONT FASTENED, F, F, TERMINAL, QUICK	Amphenol LTW 安費諾亮泰企業股份有限公司	ITEM NO CUD-00PFFE-QC5002	DRAWN BY Jiahe Lin	DATE 2024/03/06
TOLERANCE .X ±0.25 .XX ±0.1 .XXX ±0.05 ANGLES ±1°	SCALE 1:1	SHEET 1 OF 1	DWG NO CUD-00PFFE-QC5002	CHECKED BY Fisher Wang	DATE 2024/03/06
REV. 01	SIZE A4	@C: Inspection Item	CUSTOMER ALTW	APPROVED BY Kevin Hu	DATE 2024/03/06

8WI0814-03-表單 01A2

VISIT OUR WEBSITE
www.q-flex.fi

CONTACT US
info@q-flex.fi